

B SERIES COMPACT EXCAVATORS

E30_B**E35_B****E55_{BX}**

- Responsive, fuel-saving power
- Superior 360° visibility
- iNDR System for cool, quiet comfort
- Dig, grade and level for jobsite versatility
- Heavy-duty design for extreme reliability



ADD MORE MINUTES TO YOUR DAY.

Get ready to boost your daily productivity with the smooth, responsive power of compact excavators from New Holland. Comfort and versatility are part of their design. New Holland compact excavators not only allow you to excavate, grade and backfill with one machine, they allow you to save fuel and time while doing it.

RESTRICTED AREAS? NO SWEAT.

New Holland compact excavators put big digging power into tight spaces. The center-swing boom arm lets you dig, fill and grade along near-perpendicular angles like footings, curbs and foundations. The boom light is now positioned snugly under the boom, not on the side where it could be damaged. And, zero tail swing* means you operate in confidence, knowing your machine always operates within the track footprint.



• NEW! Integrated Noise and Dust Reduction (iNDR) cooling system makes the New Holland cab even more pleasant and quiet.



• Center-swing boom means you can work right next to obstacles.

• Zero tail swing* allows for no-worry operation in tight spots.



• Optional 4-way blade provides better control to follow changing terrain, helping to eliminate the windrowing effect that can occur with standard dozer blades.

• iNDR+E option with downward exhaust saves plants and shrubs from drying heat and exhaust.

HEAVY-DUTY BY DESIGN

These excavators are ruggedly built to deliver outstanding performance, day after day. In fact, these heavy-duty models feature many of the same robust design features found only on larger excavators:

- Long X-frame that provides excellent stability and support
- Thick gauge steel booms and arms that deliver superior strength
- Sealed rollers, sprockets and travel motors that extend undercarriage life

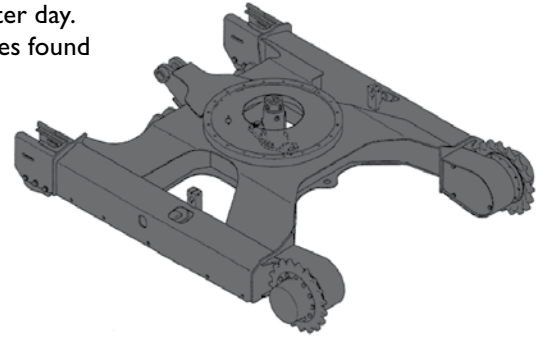

- Auxiliary hydraulics are standard equipment so New Holland compact excavators are factory-ready for grapples, breakers and specialized attachments that expand on-the-job versatility and improve your bottom line.

Ground-level maintenance checkpoints are easy to access with convenient swing-out panels.



- Hydraulically controlled dozer blade is standard to give you added versatility for site prep, backfilling and general grading. The unique blade profile efficiently rolls dirt as it pushes, creating a smooth “wave” of material and creating a smooth, level surface.

- New, clean-running Tier 4 Final engines reduce emissions while saving you fuel.

COMPLETE COMFORT & VISIBILITY. TOTAL CONTROL.

With New Holland, operators come first, so New Holland compact excavators are designed for maximum control and comfort.

AN EASY VIEW

Choose a 4-post ROPS/canopy or fully enclosed cab with standard air conditioning. Either choice gives you a clear all-direction view for confident, relaxed operation. On cab models, the air conditioner unit is positioned out of your line of sight



AN OPEN DESIGN WITH CONVENIENT SLIDING DOOR

A wide entry welcomes you to the operator station, and you'll appreciate the foot and shoulder room New Holland excavators offer. The adjustable seat and wrist supports allow for personalized comfort. The convenient sliding cab door (models E30B and E35B) maintains your excavator's footprint by gliding open within the machine frame so it's never in the way.



NEW! FOR THE FIRST TIME IN COMPACT EXCAVATORS: INDR for quiet comfort

Here's something you won't find on most compact excavators—an Integrated Noise and Dust Reduction (iNDR) cooling system. The system reduces noise by up to 9 dB—a difference you'll notice. The filter located in front of the radiator is easy to remove and clean with compressed air and reduces the need for direct cleaning of the radiator.

NEW! Fuel-saving mode delivers 23 to 25% fuel savings

New Holland compact excavators now feature a new fuel-saving mode that reduces fuel consumption drastically compared to high-idle mode. You position the throttle to one of three positions—low, “S” for fuel-saving, and “H” for high idle.





NEW! Downward exhaust protects plants

Specify the iNDR+E option to eliminate worry that plants, trees or structures will be damaged by heated exhaust. Instead of discharging heated exhaust wind and exhaust gas to the side where it can dry nearby shrubs and plants, the design of the new +E option draws air from the front of the machine and discharges it under the machine using a diffusion muffler for reduced air force.

Smart integrated-flow hydraulic system

The new 2-pump integrated-flow hydraulic system directs power only where you need it for maximum efficiency. Power is automatically sent to bucket and arm when excavating, to the boom when raising and swinging, and to the tracks and dozer blade when grading.

Natural controls

Precision controls are positioned ergonomically—for instinctive operation. Operators can toggle between ISO (excavator) and SAE (backhoe) control patterns to match their preference. The pattern selector and auxiliary hydraulic selector (breaker/nibbler) are positioned under the front of the operator station for convenient changes.

Automatic 2-speed selection

Your compact excavator automatically chooses the speed that matches jobsite conditions, so you can concentrate on the work at hand.



NEW! LCD color display option

Choose conventional analog gauges or the optional new LCD color monitor that provides easy tracking of operations and maintenance.

- Operational achievement of past 3 months
- Fuel and water temperature gauges
- Replacement indicators for engine oil, fuel filter, hydraulic oil filter and hydraulic oil

SPECIFICATIONS

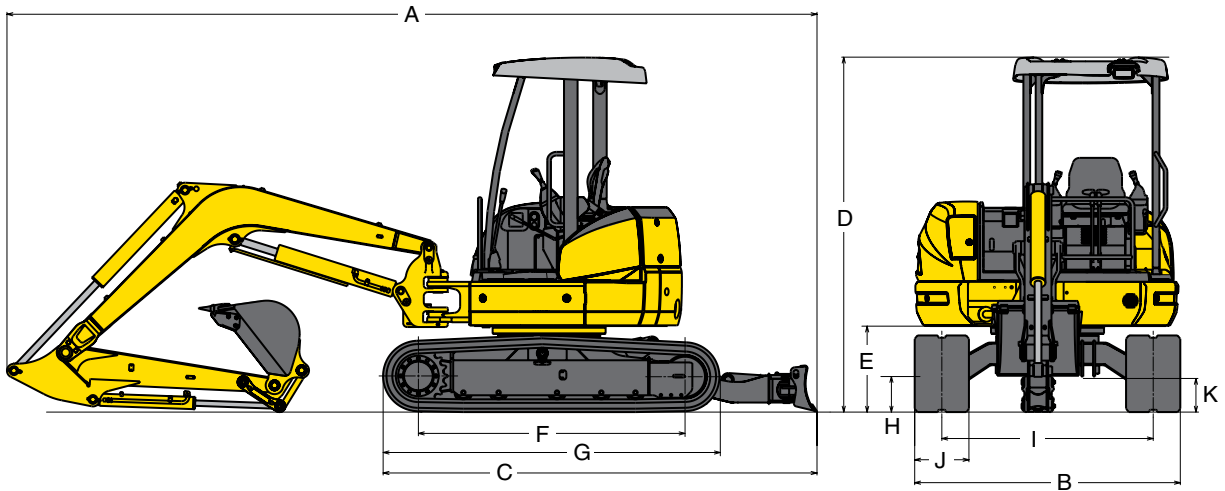

DIMENSIONS, ft. (m)		E30B	E35B	E55Bx
	Arm length	4' 4" (1.32)	4' 4" (1.32)	5' 6.5" (1.69)
	Boom length	7' 7" (2.31)	8' 2" (2.50)	9' 6" (2.89)
A.	Overall length	15' 6" (4.73)	15' 5" (4.82)	18' (5.5)
B.	Overall width	5' 1" (1.55)	5' 7" (1.70)	6' 5" (1.96)
C.	Base machine length	8' 8" (2.64)	8' 8" (2.63)	9' 7" (2.92)
D.	Overall height (to top of canopy)	8' 3" (2.51)	8' 3" (2.51)	8' 3" (2.53)
E.	Ground clearance of rear end	1' 10" (0.57)	1' 10" (0.57)	2' 0.5" (0.625)
F.	Center distance of tumbler	5' 7" (1.70)	5' 7" (1.70)	6' 6" (2.0)
G.	Overall length of crawler	7' 1" (2.16)	7' 1" (2.16)	8' 2" (2.5)
H.	Crawler height at tumbler center (less grouser bar)	1' 8" (0.50)	1' 8" (0.50)	1' 9" (0.53)
I.	Track gauge	4' 1" (1.25)	4' 7" (1.40)	5' 1" (1.56)
J.	Width of crawler shoe (rubber)	11.8" (0.30)	11.8" (0.30)	15.7" (0.40)
K.	Ground clearance of undercarriage	11.8" (0.30)	11.8" (0.30)	12" (0.32)

ENGINE		E30B	E35B	E55Bx
	Model	Yanmar 3TNV88F-E	Yanmar 3TNV88-BPYB	Yanmar 4TNV88 BXPYBD
	Displacement, cu in (l)	100.2 (1.642)	100.2 (1.642)	133.5 (2.2)
	Horsepower SAE NET, hp (kW) @ rpm	17.2 (12.8) @ 2,400	28.4 (21.2) @ 2,400	37.9 (28.3) @ 2,400

PERFORMANCE		E30B	E35B	E55Bx
	Base machine weight, lb (kg)	7,319 (3320)	7,763 (3521)	12,295 (5130)
	Travel speed (turtle), mph (km/h)	1.6 (2.50)	1.6 (2.50)	1.4 (2.2)
	Travel speed (rabbit), mph (km/h)	2.7 (4.40)	2.8 (4.50)	2.5 (4.0)
	Drawbar pull force, lb (kN)	8,610 (38.3)	8,655 (38.49)	12,342 (54.9)
	Swing speed, rpm	8.4	8.9	8.5
	Gradeability, degrees (%)	30 (58)	30 (58)	30 (58)

BREAKOUT FORCES		E30B	E35B	E55Bx
	Arm breakout force, SAE lbf (kN)	4,092 (18.2)	4,811 (21.4)	5,328 (23.7)
	Bucket breakout force, SAE lbf (kN)	5,418 (24.1)	5,418 (24.1)	6,992 (31.1)

SERVICE CAPACITIES		E30B	E35B	E55Bx
	Fuel tank capacity, gal (l)	11 (42)	11 (42)	19.8 (75)
	Hydraulic oil reservoir, gal (l)	5.4 (20.4)	5.4 (20.4)	7.3 (27.9)
	Hydraulic system including oil reservoir, gal (l)	11.8 (44.8)	11.8 (44.8)	15.2 (57.7)
	Cooling system, gal (l)	1 (3.6)	1 (3.6)	1.5 (6)
	Lubrication: engine oil, gal (l)	1.5 (5.5)	1.5 (5.5)	1.9 (7.4)

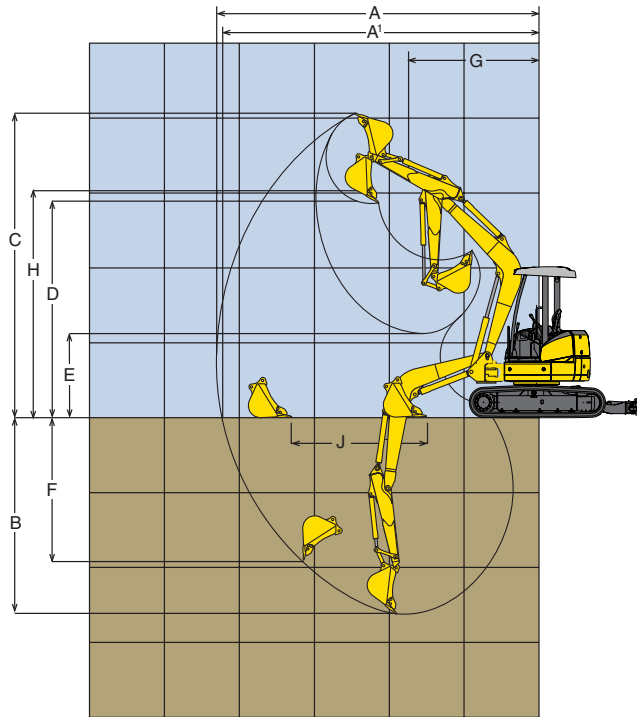

WORKING RANGES, ft. (m)		E30B		E35B		E55Bx
		Standard Arm	Long Arm	Standard Arm	Long Arm	
A.	Max digging reach	17' 0" (5.18)	18' 0" (5.49)	17' 2" (5.24)	18' 6" (5.64)	20' 5" (6.24)
A1.	Max digging reach at ground level	16' 6" (5.04)	17' 6" (5.34)	16' 9" (5.11)	18' 0" (5.49)	20' (6.10)
B.	Max digging depth	9' 3" (2.82)	10' 3" (3.13)	10' 1" (3.08)	12' 0" (3.35)	12' 9" (3.90)
C.	Max digging height	15' 9" (4.80)	16' 5" (5.00)	16' 4" (4.98)	16' 7" (5.05)	14' 3" (4.35)
D.	Max dumping clearance	11' 3" (3.42)	11' 10" (3.60)	11' 9" (3.58)	12' 0" (3.67)	14' 3" (4.35)
E.	Min dumping clearance	4' 3" (1.30)	3' 3" (0.995)	4' 7" (1.41)	3' 4" (1.01)	5' 2" (1.58)
F.	Max vertical wall digging depth	7' 9" (2.36)	9' 6" (2.86)	7' 10" (2.39)	9' 1" (2.76)	10' 3" (3.14)
G.	Min front swing radius	7' 6" (2.30)	7' 8" (2.34)	6' 8" (2.04)	7' 8" (2.33)	7' 4" (2.25)
H.	Height at min front swing radius	12' 2" (3.70)	12' 2" (3.70)	12' 5" (3.78)	12' 6" (3.80)	14' 8" (4.48)
J.	Horizontal digging stroke - ground level	5' 7" (1.71)	8' 8" (2.64)	7' 9" (2.37)	9' 5" (2.86)	9' 10" (3.00)
	Ground pressure, psi (kPa)	4.19 (28.9)	—	4.64 (32)	—	4.09 (28.2)



COMPACT EXCAVATORS

E30B

Operating Weight
7,319 lbs (3320 kg)

SAE NET Horsepower
17.2 (12.8 kW) @ 2,400 rpm

Max Digging Depth
9' 3" (2.82 m)

Bucket Breakout Force
(SAE) 5,418 lbf (24.1 kN)

E35B

Operating Weight
8,212 lbs (3725 kg)

SAE NET Horsepower
28.4 (21.2 kW) @ 2,400 rpm

Max Digging Depth
10' 1" (3.08 m)

Bucket Breakout Force
(SAE) 5,417 lbf (24.1 kN)

E55Bx

Operating Weight
11,309 lbs (5130 kg)

SAE NET Horsepower
37.9 (28.3 kW) @ 2,400 rpm

Max Digging Depth
12' 9" (3.90 m)

Bucket Breakout Force
(SAE) 6,992 lbf (31.1 kN)

World Class Products Demand World Class Dealers

The purchase of a New Holland machine is just the beginning of our relationship together. Consider your experienced New Holland Construction equipment dealer as your local partner in productivity. Assistance in selecting the right model for your operation and developing an affordable leasing or financing plan through New Holland's financing division, CNH Capital, are just a few advantages your local dealer can provide.

Your New Holland dealer's full service capabilities bring you responsive support with genuine New Holland parts and all makes coverage. More importantly, we are there wherever and whenever you need us with our fully equipped service vehicles. From customized maintenance programs to professional operator and technical training, our factory-trained service and parts experts are there to assist you with any of your equipment support needs.

Your business deserves nothing less than world class product, supported by a world class business partner. That's your New Holland Construction Equipment dealer — your partner in productivity.



New Holland Construction
500 Diller Ave.
New Holland, PA 17557

www.newholland.com

New Holland Construction Equipment is backed with a Limited Warranty for 1-Year/Unlimited Hours. See the Warranty and Limitation of Liability for warranty details and terms.

Design, materials and/or specifications are subject to change without notice and without liability therefor. Specifications are applicable to units sold in Canada, the United States, its territories and possessions, and may vary outside these areas.

© 2014 CNH Industrial America LLC. All rights reserved. New Holland is a trademark in the United States and many other countries, owned by or licensed to CNH Industrial N.V., its subsidiaries or affiliates. Any trademarks referred to herein, in association with goods and/or services of companies other than CNH America LLC, are the property of those respective companies.



Safety begins with a thorough understanding of the equipment. Always make sure you and your operators read the Operator's Manual before using the equipment. Pay close attention to all safety and operating decals and never operate machinery without all shields, protective devices and structures in place. This is a one-person machine. Never allow riders in the cab, outside the machine, or in/on any bucket or attachment.

NHC201410Excavators • 011510 • AC • PRINTED IN U.S.A.

 Printed on recycled paper